



Epping Forest
Application for a premises licence
Licensing Act 2003

For help contact
licensing@eppingforestdc.gov.uk
 Telephone: 01992 564000

* required information

Section 1 of 21

You can save the form at any time and resume it later. You do not need to be logged in when you resume.

System reference

Not Currently In Use

This is the unique reference for this application generated by the system.

Your reference

You can put what you want here to help you track applications if you make lots of them. It is passed to the authority.

Are you an agent acting on behalf of the applicant?

☐ Yes

☒ No

Put "no" if you are applying on your own behalf or on behalf of a business you own or work for.

Applicant Details

* First name

YING LEUNG TOM

* Family name

CHEUNG

* E-mail

Main telephone number

02085080464

Include country code.

Other telephone number

☒ Indicate here if you would prefer not to be contacted by telephone

Are you:

☒ Applying as a business or organisation, including as a sole trader

☐ Applying as an individual

A sole trader is a business owned by one person without any special legal structure. Applying as an individual means you are applying so you can be employed, or for some other personal reason, such as following a hobby.

Applicant Business

Is your business registered in the UK with Companies House?

☒ Yes

☐ No

Note: completing the Applicant Business section is optional in this form.

Registration number

12144308

Business name

WIN RISE LTD

If your business is registered, use its registered name.

VAT number

-

331399500

Put "none" if you are not registered for VAT.

Legal status

Private Limited Company

Continued from previous page...

Your position in the business

Home country

The country where the headquarters of your business is located.

Registered Address

Address registered with Companies House.

Building number or name

Street

District

City or town

County or administrative area

Postcode

Country

Section 2 of 21

PREMISES DETAILS

I/we, as named in section 1, apply for a premises licence under section 17 of the Licensing Act 2003 for the premises described in section 2 below (the premises) and I/we are making this application to you as the relevant licensing authority in accordance with section 12 of the Licensing Act 2003.

Premises Address

Are you able to provide a postal address, OS map reference or description of the premises?

☒ Address ☐ OS map reference ☐ Description

Postal Address Of Premises

Building number or name

Street

District

City or town

County or administrative area

Postcode

Country

Further Details

Telephone number

Non-domestic rateable value of premises (£)

Section 3 of 21

APPLICATION DETAILS

In what capacity are you applying for the premises licence?

- ☐ An individual or individuals
- ☒ A limited company / limited liability partnership
- ☐ A partnership (other than limited liability)
- ☐ An unincorporated association
- ☐ Other (for example a statutory corporation)
- ☐ A recognised club
- ☐ A charity
- ☐ The proprietor of an educational establishment
- ☐ A health service body
- ☐ A person who is registered under part 2 of the Care Standards Act 2000 (c14) in respect of an independent hospital in Wales
- ☐ A person who is registered under Chapter 2 of Part 1 of the Health and Social Care Act 2008 in respect of the carrying on of a regulated activity (within the meaning of that Part) in an independent hospital in England
- ☐ The chief officer of police of a police force in England and Wales

Confirm The Following

- ☒ I am carrying on or proposing to carry on a business which involves the use of the premises for licensable activities
- ☐ I am making the application pursuant to a statutory function
- ☐ I am making the application pursuant to a function discharged by virtue of Her Majesty's prerogative

Section 4 of 21

NON INDIVIDUAL APPLICANTS

Provide name and registered address of applicant in full. Where appropriate give any registered number. In the case of a partnership or other joint venture (other than a body corporate), give the name and address of each party concerned.

Non Individual Applicant's Name

Name

Details

Registered number (where applicable)

Description of applicant (for example partnership, company, unincorporated association etc)

Continued from previous page...

Address

Building number or name

Street

District

City or town

County or administrative area

Postcode

Country

Contact Details

E-mail

Telephone number

Other telephone number

* Date of birth / /
dd mm yyyy

* Nationality Documents that demonstrate entitlement to work in the UK

[Add another applicant](#)

Section 5 of 21

OPERATING SCHEDULE

When do you want the premises licence to start? / /
dd mm yyyy

If you wish the licence to be valid only for a limited period, when do you want it to end / /
dd mm yyyy

Provide a general description of the premises

For example the type of premises, its general situation and layout and any other information which could be relevant to the licensing objectives. Where your application includes off-supplies of alcohol and you intend to provide a place for consumption of these off-supplies you must include a description of where the place will be and its proximity to the premises.

WE ARE APPLYING A PREMISES LICENCE FOR A CHINESE RESTAURANT SITUATES AT 270-272 HIGH ROAD IN LOUGHTON IG10 1RB. THE NAME OF THE RESTAURANT IS WO FAT. WO FAT PROVIDES HOT FOODS FOR SIT IN CUSTOMERS AND ALSO HAVE TAKEAWAY SERVICES.

Continued from previous page...

If 5,000 or more people are expected to attend the premises at any one time, state the number expected to attend

65

Section 6 of 21

PROVISION OF PLAYS

See guidance on regulated entertainment

Will you be providing plays?

☐ Yes

☒ No

Section 7 of 21

PROVISION OF FILMS

See guidance on regulated entertainment

Will you be providing films?

☐ Yes

☒ No

Section 8 of 21

PROVISION OF INDOOR SPORTING EVENTS

See guidance on regulated entertainment

Will you be providing indoor sporting events?

☐ Yes

☒ No

Section 9 of 21

PROVISION OF BOXING OR WRESTLING ENTERTAINMENTS

See guidance on regulated entertainment

Will you be providing boxing or wrestling entertainments?

☐ Yes

☒ No

Section 10 of 21

PROVISION OF LIVE MUSIC

See guidance on regulated entertainment

Will you be providing live music?

☐ Yes

☒ No

Section 11 of 21

PROVISION OF RECORDED MUSIC

See guidance on regulated entertainment

Will you be providing recorded music?

☒ Yes

☐ No

Standard Days And Timings

Continued from previous page...

MONDAY

Start 12:00

End 14:30

Start 17:00

End 23:00

Give timings in 24 hour clock.
(e.g., 16:00) and only give details for the days
of the week when you intend the premises
to be used for the activity.

TUESDAY

Start 12:00

End 14:30

Start 17:00

End 23:00

WEDNESDAY

Start 12:00

End 14:30

Start 17:00

End 23:00

THURSDAY

Start 12:00

End 14:30

Start 17:00

End 23:00

FRIDAY

Start 12:00

End 14:30

Start 17:00

End 23:30

SATURDAY

Start 12:00

End 14:30

Start 17:00

End 23:30

SUNDAY

Start 12:00

End 23:00

Start

End

Will the playing of recorded music take place indoors or outdoors or both?

☒ Indoors ☐ Outdoors ☐ Both

Where taking place in a building or other
structure tick as appropriate. Indoors may
include a tent.

State type of activity to be authorised, if not already stated, and give relevant further details, for example (but not
exclusively) whether or not music will be amplified or unamplified.

NOT APPLY

State any seasonal variations for playing recorded music

For example (but not exclusively) where the activity will occur on additional days during the summer months.

NOT APPLY

Continued from previous page...

Non-standard timings. Where the premises will be used for the playing of recorded music at different times from those listed in the column on the left, list below

For example (but not exclusively), where you wish the activity to go on longer on a particular day e.g. Christmas Eve.

NOT APPLY

Section 12 of 21

PROVISION OF PERFORMANCES OF DANCE

See guidance on regulated entertainment

Will you be providing performances of dance?

☐ Yes

☒ No

Section 13 of 21

PROVISION OF ANYTHING OF A SIMILAR DESCRIPTION TO LIVE MUSIC, RECORDED MUSIC OR PERFORMANCES OF DANCE

See guidance on regulated entertainment

Will you be providing anything similar to live music, recorded music or performances of dance?

☐ Yes

☒ No

Section 14 of 21

LATE NIGHT REFRESHMENT

Will you be providing late night refreshment?

☒ Yes

☐ No

Standard Days And Timings

MONDAY

Start

End

Start

End

TUESDAY

Start

End

Start

End

WEDNESDAY

Start

End

Start

End

THURSDAY

Start

End

Start

End

Give timings in 24 hour clock.
(e.g., 16:00) and only give details for the days
of the week when you intend the premises
to be used for the activity.

Continued from previous page...

FRIDAY

Start 23:00

End 23:30

Start

End

SATURDAY

Start 23:00

End 23:30

Start

End

SUNDAY

Start

End

Start

End

Will the provision of late night refreshment take place indoors or outdoors or both?

☒ Indoors

☐ Outdoors

☐ Both

Where taking place in a building or other structure tick as appropriate. Indoors may include a tent.

State type of activity to be authorised, if not already stated, and give relevant further details, for example (but not exclusively) whether or not music will be amplified or unamplified.

SUPPLY NORMALLY RESTAURANT MEAL ONLY NO AMPLIFIED MUSIC.

State any seasonal variations

For example (but not exclusively) where the activity will occur on additional days during the summer months.

NA

Non-standard timings. Where the premises will be used for the supply of late night refreshments at different times from those listed in the column on the left, list below

For example (but not exclusively), where you wish the activity to go on longer on a particular day e.g. Christmas Eve.

NA

Section 15 of 21

SUPPLY OF ALCOHOL

Will you be selling or supplying alcohol?

☒ Yes

☐ No

Continued from previous page...

Standard Days And Timings

MONDAY

Start

End

Start

End

Give timings in 24 hour clock.
(e.g., 16:00) and only give details for the days
of the week when you intend the premises
to be used for the activity.

TUESDAY

Start

End

Start

End

WEDNESDAY

Start

End

Start

End

THURSDAY

Start

End

Start

End

FRIDAY

Start

End

Start

End

SATURDAY

Start

End

Start

End

SUNDAY

Start

End

Start

End

Will the sale of alcohol be for consumption:

- ☒ On the premises ☐ Off the premises ☐ Both

If the sale of alcohol is for consumption on
the premises select on, if the sale of alcohol
is for consumption away from the premises
select off. If the sale of alcohol is for
consumption on the premises and away
from the premises select both.

State any seasonal variations

For example (but not exclusively) where the activity will occur on additional days during the summer months.

NA

Continued from previous page...

Non-standard timings. Where the premises will be used for the supply of alcohol at different times from those listed in the column on the left, list below

For example (but not exclusively), where you wish the activity to go on longer on a particular day e.g. Christmas Eve.

NA

State the name and details of the individual whom you wish to specify on the licence as premises supervisor

Name

First name

YING LEUNG TOM

Family name

CHEUNG

Date of birth

/ /
dd mm yyyy

Enter the contact's address

Building number or name

Street

District

City or town

LOUGHTON

County or administrative area

ESSEX

Postcode

Country

United Kingdom

Personal Licence number
(if known)

Issuing licensing authority
(if known)

PROPOSED DESIGNATED PREMISES SUPERVISOR CONSENT

How will the consent form of the proposed designated premises supervisor be supplied to the authority?

- ☐ Electronically, by the proposed designated premises supervisor
- ☒ As an attachment to this application

Reference number for consent
form (if known)

If the consent form is already submitted, ask the proposed designated premises supervisor for its 'system reference' or 'your reference'.

Continued from previous page...

Section 16 of 21

ADULT ENTERTAINMENT

Highlight any adult entertainment or services, activities, or other entertainment or matters ancillary to the use of the premises that may give rise to concern in respect of children

Give information about anything intended to occur at the premises or ancillary to the use of the premises which may give rise to concern in respect of children, regardless of whether you intend children to have access to the premises, for example (but not exclusively) nudity or semi-nudity, films for restricted age groups etc gambling machines etc.

NA

Section 17 of 21

HOURS PREMISES ARE OPEN TO THE PUBLIC

Standard Days And Timings

MONDAY

Start

End

Start

End

Give timings in 24 hour clock.
(e.g., 16:00) and only give details for the days
of the week when you intend the premises
to be used for the activity.

TUESDAY

Start

End

Start

End

WEDNESDAY

Start

End

Start

End

THURSDAY

Start

End

Start

End

FRIDAY

Start

End

Start

End

SATURDAY

Start

End

Start

End

SUNDAY

Start

End

Start

End

State any seasonal variations

Continued from previous page...

For example (but not exclusively) where the activity will occur on additional days during the summer months.

NA

Non standard timings. Where you intend to use the premises to be open to the members and guests at different times from those listed in the column on the left, list below

For example (but not exclusively), where you wish the activity to go on longer on a particular day e.g. Christmas Eve.

NA

Section 18 of 21

LICENSING OBJECTIVES

Describe the steps you intend to take to promote the four licensing objectives:

a) General – all four licensing objectives (b,c,d,e)

List here steps you will take to promote all four licensing objectives together.

WE WILL TRAIN ALL STAFFS WORKING IN THE RESTAURANT : DO NOT SELL ALCOHOLIC DRINK TO PERSON UNDER THE AGE OF 18 YEAR OLD. (REQUEST FOR ID IF IN DOUBT). DO NOT SELL ALCOHOLIC DRINK TO A PERSON APPEARS TO BE VERY DRUNK.

b) The prevention of crime and disorder

WE WILL INSTALL VIDEO/CCTV EQUIPMENT INSIDE AND OUTSIDE THE PREMISES AND ENSURE THAT IT IS MAINTAINED IN WORKING ORDER.

WE WILL SET VIDEO/CCTV EQUIPMENT TO RECORD 24 HOURS A DAY.

c) Public safety

WE WILL BE RESPONSIBLE FOR THE DISPOSAL OF WASTE ON THE FRONTAGE OF THE PREMISES.

WE WILL ENSURE THAT THE MAXIMUM OCCUPANCY OF THE LICENCE PREMISES IS RESTRICTED TO 80 PEOPLE AT ANY TIME.

d) The prevention of public nuisance

WE WILL ENSURE THAT THE CONSUMPTION OF ALCOHOL IS RESTRICTED TO THE RESTAURANT AREA (CUSTOMER SEATING) AS INDICATED ON THE GROUND FLOOR PLAN DRAWING.

e) The protection of children from harm

WE WILL ENSURE THAT ANY PERSON SELLING OR SUPPLYING ALCOHOLIC DRINK UNDER THE AUTHORITY OF A PERSONAL LICENCE HOLDER ASKS FOR A PHOTO ID PROOF OF AGE WHERE THEY HAVE REASON TO SUSPECT THAT THE INDIVIDUAL

Continued from previous page...

MAY BE UNDER 18 YEARS OF AGE.

Section 19 of 21

NOTES ON DEMONSTRATING ENTITLEMENT TO WORK IN THE UK

Entitlement to work/immigration status for individual applicants and applications from partnerships which are not limited liability partnerships:

A licence may not be held by an individual or an individual in a partnership who is resident in the UK who:

- does not have the right to live and work in the UK; or
- is subject to a condition preventing him or her from doing work relating to the carrying on of a licensable activity.

Any premises licence issued in respect of an application made on or after 6 April 2017 will become invalid if the holder ceases to be entitled to work in the UK.

Applicants must demonstrate that they have an entitlement to work in the UK and are not subject to a condition preventing them from doing work relating to the carrying on of a licensable activity. They do this in one of two ways: 1) by providing with this application copies or scanned copies of the documents listed below (which do not need to be certified), or 2) by providing their 'share code' to enable the licensing authority to carry out a check using the Home Office online right to work checking service (see below).

Documents which demonstrate entitlement to work in the UK

- An expired or current passport showing the holder, or a person named in the passport as the child of the holder, is a British citizen or a citizen of the UK and Colonies having the right of abode in the UK [please see note below about which sections of the passport to copy].
- An expired or current passport or national identity card showing the holder, or a person named in the passport as the child of the holder, is a national of a European Economic Area country or Switzerland.
- A Registration Certificate or document certifying permanent residence issued by the Home Office to a national of a European Economic Area country or Switzerland.
- A Permanent Residence Card issued by the Home Office to the family member of a national of a European Economic Area country or Switzerland.
- A **current** Biometric Immigration Document (Biometric Residence Permit) issued by the Home Office to the holder indicating that the person named is allowed to stay indefinitely in the UK, or has no time limit on their stay in the UK.
- A **current** passport endorsed to show that the holder is exempt from immigration control, is allowed to stay indefinitely in the UK, has the right of abode in the UK, or has no time limit on their stay in the UK.
- A **current** Immigration Status Document issued by the Home Office to the holder with an endorsement indicating that the named person is allowed to stay indefinitely in the UK or has no time limit on their stay in the UK, **when produced in combination with** an official document giving the person's permanent National Insurance number and their name issued by a Government agency or a previous employer.
- A birth or adoption certificate issued in the UK, **when produced in combination with** an official document giving the person's permanent National Insurance number and their name issued by a Government agency or a previous employer.
- A birth or adoption certificate issued in the Channel Islands, the Isle of Man or Ireland **when produced in combination with** an official document giving the person's permanent National Insurance number and their name issued by a Government agency or a previous employer.
- A certificate of registration or naturalisation as a British citizen, **when produced in combination with** an official document giving the person's permanent National Insurance number and their name issued by a Government agency or a previous employer.

Continued from previous page...

- A **current** passport endorsed to show that the holder is allowed to stay in the UK and is currently allowed to work and is not subject to a condition preventing the holder from doing work relating to the carrying on of a licensable activity.
- A **current** Biometric Immigration Document (Biometric Residence Permit) issued by the Home Office to the holder which indicates that the named person can currently stay in the UK and is allowed to work relation to the carrying on of a licensable activity.
- A **current** Residence Card issued by the Home Office to a person who is not a national of a European Economic Area state or Switzerland but who is a family member of such a national or who has derivative rights or residence.
- A **current** Immigration Status Document containing a photograph issued by the Home Office to the holder with an endorsement indicating that the named person may stay in the UK, and is allowed to work and is not subject to a condition preventing the holder from doing work relating to the carrying on of a licensable activity **when produced in combination with** an official document giving the person's permanent National Insurance number and their name issued by a Government agency or a previous employer.
- A Certificate of Application, **less than 6 months old**, issued by the Home Office under regulation 18(3) or 20(2) of the Immigration (European Economic Area) Regulations 2016, to a person who is not a national of a European Economic Area state or Switzerland but who is a family member of such a national or who has derivative rights of residence.
- Reasonable evidence that the person has an outstanding application to vary their permission to be in the UK with the Home Office such as the Home Office acknowledgement letter or proof of postage evidence, or reasonable evidence that the person has an appeal or administrative review pending on an immigration decision, such as an appeal or administrative review reference number.
- Reasonable evidence that a person who is not a national of a European Economic Area state or Switzerland but who is a family member of such a national or who has derivative rights of residence in exercising treaty rights in the UK including:-
 - evidence of the applicant's own identity – such as a passport,
 - evidence of their relationship with the European Economic Area family member – e.g. a marriage certificate, civil partnership certificate or birth certificate, and
 - evidence that the European Economic Area national has a right of permanent residence in the UK or is one of the following if they have been in the UK for more than 3 months:
 - (i) working e.g. employment contract, wage slips, letter from the employer,
 - (ii) self-employed e.g. contracts, invoices, or audited accounts with a bank,
 - (iii) studying e.g. letter from the school, college or university and evidence of sufficient funds; or
 - (iv) self-sufficient e.g. bank statements.

Family members of European Economic Area nationals who are studying or financially independent must also provide evidence that the European Economic Area national and any family members hold comprehensive sickness insurance in the UK. This can include a private medical insurance policy, an EHIC card or an S1, S2 or S3 form.

Original documents must not be sent to licensing authorities. If the document copied is a passport, a copy of the following pages should be provided:-

- (i) any page containing the holder's personal details including nationality;
- (ii) any page containing the holder's photograph;
- (iii) any page containing the holder's signature;
- (iv) any page containing the date of expiry; and
- (v) any page containing information indicating the holder has permission to enter or remain in the UK and is permitted to work.

Continued from previous page...

If the document is not a passport, a copy of the whole document should be provided.

Your right to work will be checked as part of your licensing application and this could involve us checking your immigration status with the Home Office. We may otherwise share information with the Home Office. Your licence application will not be determined until you have complied with this guidance.

Home Office online right to work checking service

As an alternative to providing a copy of the documents listed above, applicants may demonstrate their right to work by allowing the licensing authority to carry out a check with the Home Office online right to work checking service.

To demonstrate their right to work via the Home Office online right to work checking service, applicants should include in this application their 9-digit share code (provided to them upon accessing the service at <https://www.gov.uk/prove-right-to-work>) which, along with the applicant's date of birth (provided within this application), will allow the licensing authority to carry out the check.

In order to establish the applicant's right to work, the check will need to indicate that the applicant is allowed to work in the United Kingdom and is not subject to a condition preventing them from doing work relating to the carrying on of a licensable activity.

An online check will not be possible in all circumstances because not all applicants will have an immigration status that can be checked online. The Home Office online right to work checking service sets out what information and/or documentation applicants will need in order to access the service. Applicants who are unable to obtain a share code from the service should submit copy documents as set out above.

Section 20 of 21

NOTES ON REGULATED ENTERTAINMENT

Continued from previous page...

In terms of specific **regulated entertainments** please note that:

- Plays: no licence is required for performances between 08:00 and 23:00 on any day, provided that the audience does not exceed 500.
- Films: no licence is required for 'not-for-profit' film exhibition held in community premises between 08:00 and 23:00 on any day provided that the audience does not exceed 500 and the organiser (a) gets consent to the screening from a person who is responsible for the premises; and (b) ensures that each such screening abides by age classification ratings.
- Indoor sporting events: no licence is required for performances between 08:00 and 23:00 on any day, provided that the audience does not exceed 1000.
- Boxing or Wrestling Entertainment: no licence is required for a contest, exhibition or display of Greco-Roman wrestling, or freestyle wrestling between 08:00 and 23:00 on any day, provided that the audience does not exceed 1000. Combined fighting sports – defined as a contest, exhibition or display which combines boxing or wrestling with one or more martial arts – are licensable as a boxing or wrestling entertainment rather than an indoor sporting event.
- Live music: no licence permission is required for:
 - o a performance of unamplified live music between 08:00 and 23:00 on any day, on any premises.
 - o a performance of amplified live music between 08:00 and 23:00 on any day on premises authorised to sell alcohol for consumption on those premises, provided that the audience does not exceed 500.
 - o a performance of amplified live music between 08:00 and 23:00 on any day, in a workplace that is not licensed to sell alcohol on those premises, provided that the audience does not exceed 500.
 - o a performance of amplified live music between 08:00 and 23:00 on any day, in a church hall, village hall, community hall, or other similar community premises, that is not licensed by a premises licence to sell alcohol, provided that (a) the audience does not exceed 500, and (b) the organiser gets consent for the performance from a person who is responsible for the premises.
 - o a performance of amplified live music between 08:00 and 23:00 on any day, at the non-residential premises of (i) a local authority, or (ii) a school, or (iii) a hospital, provided that (a) the audience does not exceed 500, and (b) the organiser gets consent for the performance on the relevant premises from: (i) the local authority concerned, or (ii) the school or (iii) the health care provider for the hospital.
- Recorded Music: no licence permission is required for:
 - o any playing of recorded music between 08:00 and 23:00 on any day on premises authorised to sell alcohol for consumption on those premises, provided that the audience does not exceed 500.
 - o any playing of recorded music between 08:00 and 23:00 on any day, in a church hall, village hall, community hall, or other similar community premises, that is not licensed by a premises licence to sell alcohol, provided that (a) the audience does not exceed 500, and (b) the organiser gets consent for the performance from a person who is responsible for the premises.
 - o any playing of recorded music between 08:00 and 23:00 on any day, at the non-residential premises of (i) a local authority, or (ii) a school, or (iii) a hospital, provided that (a) the audience does not exceed 500, and (b) the organiser gets consent for the performance on the relevant premises from: (i) the local authority concerned, or (ii) the school proprietor or (iii) the health care provider for the hospital.

Continued from previous page...

- Dance: no licence is required for performances between 08.00 and 23.00 on any day, provided that the audience does not exceed 500. However, a performance which amounts to adult entertainment remains licensable.
- Cross activity exemptions: no licence is required between 08.00 and 23.00 on any day, with no limit on audience size for:
 - o any entertainment taking place on the premises of the local authority where the entertainment is provided by or on behalf of the local authority;
 - o any entertainment taking place on the hospital premises of the health care provider where the entertainment is provided by or on behalf of the health care provider;
 - o any entertainment taking place on the premises of the school where the entertainment is provided by or on behalf of the school proprietor; and
 - o any entertainment (excluding films and a boxing or wrestling entertainment) taking place at a travelling circus, provided that (a) it takes place within a moveable structure that accommodates the audience, and (b) that the travelling circus has not been located on the same site for more than 28 consecutive days.

Section 21 of 21

PAYMENT DETAILS

This fee must be paid to the authority. If you complete the application online, you must pay it by debit or credit card.

Premises Licence Fees are determined by the non-domestic rateable value of the premises.

To find out a premises non domestic rateable value go to the Valuation Office Agency site at http://www.voa.gov.uk/business_rates/index.htm

Band A - No RV to £4300 £100.00

Band B - £4301 to £33000 £190.00

Band C - £33001 to £8700 £315.00

Band D - £87001 to £12500 £450.00*

Band E - £125001 and over £635.00*

*If the premises rateable value is in Bands D or E and the premises is primarily used for the consumption of alcohol on the premises then you are required to pay a higher fee

Band D - £87001 to £12500 £900.00

Band E - £125001 and over £1,905.00

There is an exemption from the payment of fees in relation to the provision of regulated entertainment at church halls, chapel halls or premises of a similar nature, village halls, parish or community halls, or other premises of a similar nature. The costs associated with these licences will be met by central Government. If, however, the licence also authorises the use of the premises for the supply of alcohol or the provision of late night refreshment, a fee will be required.

Schools and sixth form colleges are exempt from the fees associated with the authorisation of regulated entertainment where the entertainment is provided by and at the school or college and for the purposes of the school or college.

If you operate a large event you are subject to ADDITIONAL fees based upon the number in attendance at any one time

Capacity 5000-9999 £1,000.00

Capacity 10000 -14999 £2,000.00

Capacity 15000-19999 £4,000.00

Capacity 20000-29999 £8,000.00

Capacity 30000-39000 £16,000.00

Capacity 40000-49999 £24,000.00

Capacity 50000-59999 £32,000.00

Capacity 60000-69999 £40,000.00

Capacity 70000-79999 £48,000.00

Capacity 80000-89999 £56,000.00

Capacity 90000 and over £64,000.00

* Fee amount (£)

315.00

ATTACHMENTS

AUTHORITY POSTAL ADDRESS

Continued from previous page...

Address

| | |
|-------------------------------|----------------|
| Building number or name | 270 - 272 |
| Street | HIGH ROAD |
| District | |
| City or town | LOUGHTON |
| County or administrative area | ESSEX |
| Postcode | IG10 1RB |
| Country | United Kingdom |

DECLARATION

[Applicable to individual applicants only, including those in a partnership which is not a limited liability partnership] I understand I am not entitled to be issued with a licence if I do not have the entitlement to live and work in the UK (or if I am subject to a condition preventing me from doing work relating to the carrying on of a licensable activity) and that my licence will become invalid if I cease to be entitled to live and work in the UK. The DPS named in this application form is entitled to work in the UK (and is not subject to conditions preventing him or her from doing work relating to a licensable activity) and I have seen a copy of his or her proof of entitlement to work, if appropriate

☒ Ticking this box indicates you have read and understood the above declaration

This section should be completed by the applicant, unless you answered "Yes" to the question "Are you an agent acting on behalf of the applicant?"

| | |
|-------------------|-----------------------|
| * Full name | YING LEUNG TOM CHEUNG |
| * Capacity | DIRECTOR |
| Date (dd/mm/yyyy) | 25/10/2019 |

Add another signatory

Once you're finished you need to do the following:

1. Save this form to your computer by clicking file/save as...
2. Go back to <https://www.gov.uk/apply-for-a-licence/premises-licence/epping-forest/apply-1> to upload this file and continue with your application.

Don't forget to make sure you have all your supporting documentation to hand.

IT IS AN OFFENCE LIABLE TO SUMMARY CONVICTION TO A FINE OF ANY AMOUNT UNDER SECTION 158 OF THE LICENSING ACT 2003, TO MAKE A FALSE STATEMENT IN OR IN CONNECTION WITH THIS APPLICATION

IT IS AN OFFENCE UNDER SECTION 24B OF THE IMMIGRATION ACT 1971 FOR A PERSON TO WORK WHEN THEY KNOW, OR HAVE REASONABLE CAUSE TO BELIEVE, THAT THEY ARE DISQUALIFIED FROM DOING SO BY REASON OF THEIR IMMIGRATION STATUS. THOSE WHO EMPLOY AN ADULT WITHOUT LEAVE OR WHO IS SUBJECT TO CONDITIONS AS TO EMPLOYMENT WILL BE LIABLE TO A CIVIL PENALTY UNDER SECTION 15 OF THE IMMIGRATION, ASYLUM AND NATIONALITY ACT 2006 AND PURSUANT TO SECTION 21 OF THE SAME ACT, WILL BE COMMITTING AN OFFENCE WHERE THEY DO SO IN THE KNOWLEDGE, OR WITH REASONABLE CAUSE TO BELIEVE, THAT THE EMPLOYEE IS DISQUALIFIED

Consent of individual to being specified as premises supervisor

I YING LEUNG TOM CHEUNG

[full name of prospective premises supervisor]

Of

[home address of prospective premises supervisor]

hereby confirm that I give my consent to be specified as the designated premises supervisor in relation to the application for

PREMISES LICENCE

[type of application]

By YING LEUNG TOM CHEUNG

[name of applicant]

relating to a premises licence

[number of existing licence, if any]

for WO FAT RESTAURANT

270 – 272, HIGH ROAD, LOUGHTON, ESSEX, IG10 1RB.

[name and address of premises to which the application relates]

and any premises licence to be granted or varied in respect of this application made by

YING LEUNG TOM CHEUNG

.....
[name of applicant]

concerning the supply of alcohol at

WO FAT RESTAURANT, 270 – 272, HIGH ROAD LOUGHTON
ESSEX, IG10 1RB.

.....
[name and address of premises to which application relates]

I also confirm that I am entitled to work in the United Kingdom and am applying for, intend to apply for or currently hold a personal licence, details of which I set out below.

Personal licence number

.....
[REDACTED]

.....
[insert personal licence number, if any]

Personal licence issuing authority

.....
[REDACTED]

.....
[insert name and address and telephone number of personal licence issuing authority, if any]

| Signed

CAR

.....
[REDACTED]

Name (please print)

.....YING LEUNG TOM CHEUNG

| Date

.....1.....9-10-2019

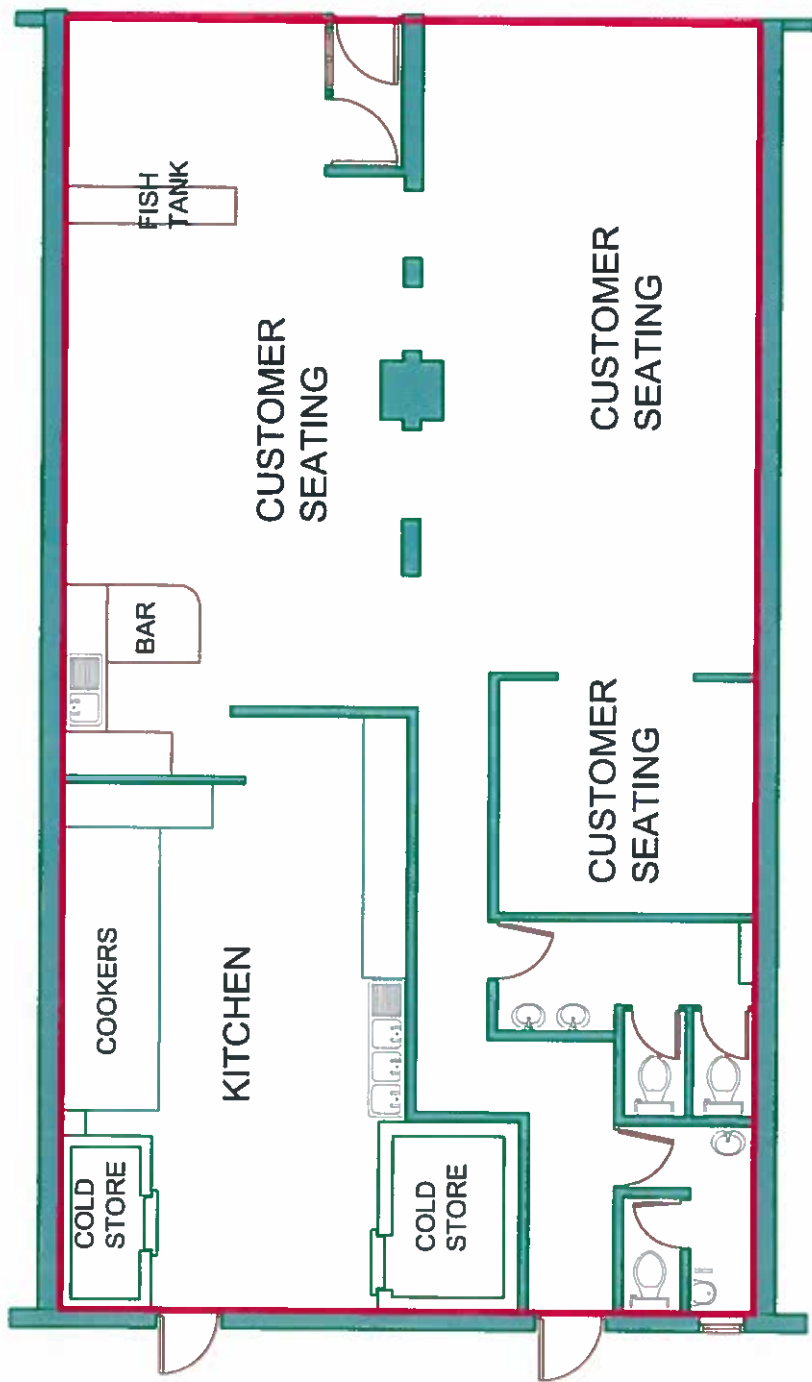

LEGEND

— Restaurant area

1:100 GROUND FLOOR PLAN



| | | | |
|-----|----|-------------------------|------------|
| B | - | Restaurant Area defined | 16.05.2019 |
| A | - | Customer Area shown | 16.05.2019 |
| Rev | By | Description | Date |

Client: **Wo Fat Restaurant**

Project: **Wo Fat Restaurant,
270-272 High Road,
Loughton, IG10 1RB**

Title: **Existing ground floor layout**

| | | | |
|----------|---------------|----------|----------|
| Date: | 04.2019 | Scale: | A4 1:100 |
| Drawn: | - | Checked: | - |
| Dwg. No: | WF-010 | Rev: | B |

► Announcements - Public Notices



Epping Forest
District Council

**Notice of Application for a New Premises
Licence under the Licensing Act 2003**

Notice is given this day 28th October 2019 that Win Rise Ltd of 138 Berkeley Close, Highwoods, Colchester, Essex, CO4 9RR has applied to the Licensing Office of Epping Forest District Council for a Premises Licence in respect of Wo Fat Restaurant 270-272 High Road, Loughton, Essex IG10 1RB. The proposed licence is for recorded music, sale of alcohol on the premises from Monday to Thursday between 12:00 to 14:30 and 17:00 to 23:00, Friday and Saturday between 12:00 to 14:30 and 17:00 to 23:30, and Sunday between 12:00 to 23:00 and provision of late night refreshment Friday and Saturday between 23:00 to 23:30. The premises opening hours are Monday to Thursday between 12:00 to 14:30 and 17:00 to 23:00, Friday and Saturday between 12:00 to 14:30 and 17:00 to 23:30, and Sunday between 12:00 to 23:00. The register of licensed premises is maintained at the Licensing Office of Epping Forest District Council, Civic Offices, High Street, Epping, Essex, CM18 4BZ. Applications for premises licences may be inspected at this office during office hours. Anyone wishing to oppose this application must give written notice to the Licensing Office within 28 days of this notice. It is an offence knowingly or recklessly to make a false statement in connection with an application which could lead to a fine on summary conviction (maximum £5000).

**BRICKIES:
LEAFLETS BUILD
YOUR BUSINESS**



**Working together
to help
businesses grow**

819k+
pages viewed
every month.

*Source: Omniture Q3 2018

**EPPING FOREST
Guardian**

To discuss your requirements

020 8884 7420

saleseast@localiq.co.

Notice of Application for a New Premises Licence under
the Licensing Act 2003

Notice is given this day 28th October 2019 that Win Rise Ltd of 138 Barkley Close, Highwoods, Colchester, Essex, CO4 9RR has applied to the Licensing Office of Epping Forest District Council for a Premises Licence in respect of Wo Fat Restaurant 270-272 High Road, Loughton, Essex IG10 1RB

The proposed licence is for recorded music, sale of alcohol on the premises from Monday to Thursday between 12:00 to 14:30 and 17:00 to 23:00, Friday and Saturday between 12:00 to 14:30 and 17:00 to 23:30, and Sunday between 12:00 to 23:00 and provision of late night refreshment Friday and Saturday between 23:00 to 23:30.

The premises opening hours are Monday to Thursday between 12:00 to 14:30 and 17:00 to 23:00, Friday and Saturday between 12:00 to 14:30 and 17:00 to 23:30, and Sunday between 12:00 to 23:00.

The register of licensed premises is maintained at the Licensing Office of Epping Forest District Council, Civic Offices, High Street, Epping, Essex, CM16 4BZ.

Applications for premises licences may be inspected at this office during office hours. Anyone wishing to oppose this application must give written notice to the Licensing Office within 28 days of this notice.

It is an offence knowingly or recklessly to make a false statement in connection with an application which could lead to a fine on summary conviction (maximum £5000)



**Epping Forest
District Council**

Register of Licence applications received.

Date application received: 28th October 2019

Applicant name: Win Rise Ltd

Address of Premises: Wo Fat Restaurant, 270-272 High Road, Loughton, Essex, IG10 1RB

Brief details of the nature of the application;

New premises licence application for a restaurant. The application is for the following:

The provision of recorded music – Monday to Thursday 12:00 – 14:30 and 17:00 – 23:00, Friday and Saturday 12:00 – 14:30 and 17:00 to 23:30 and Sunday 12:00 – 23:00

Late night refreshment – Friday and Saturday 23:00 – 23:30

Supply of Alcohol – Monday to Thursday 12:00 – 14:30 and 17:00 – 23:00, Friday and Saturday 12:00 - 14:30 and 17:00 – 23:30 and Sunday 12:00 – 23:00

Hours Premises Are Open To The Public- Monday to Thursday 12:00 – 14:30 and 17:00 – 23:00, Friday and Saturday 12:00 – 14:30 and 17:00 – 23:30 and Sunday 12:00 – 23:00

Any representations regarding the above application should be made within 28 days of the day above, to;

Epping Forest District Council
Licensing Unit Civic Offices,
High Street
Epping
Essex
CM16 4BZ

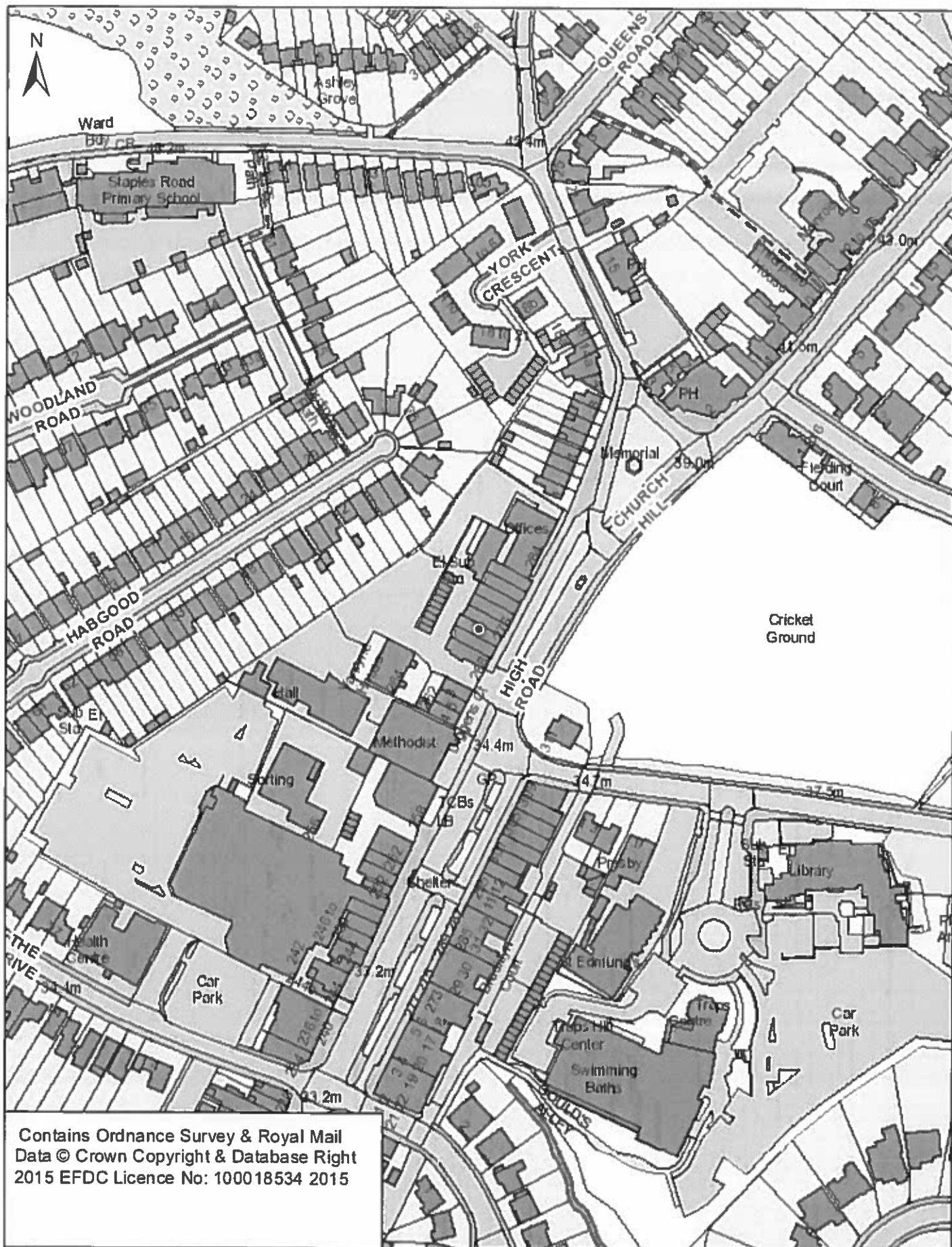

**Epping Forest
District Council**

Wo Fat, 270-272 High Road, Loughton

Date: 20/11/2019

Scale: 1:2,000

Name: arcgis

Denise Bastick

From: Debra Paris [REDACTED]
Sent: 13 November 2019 12:43
To: Handan Ibrahim; Denise Bastick
Subject: Licensing Application: Wo Fat Restaurant

CAUTION: This Message originated outside of Epping Forest District Council. Do not click links or open attachments unless you recognise the sender and know the contents is safe.

Dear Handan/Denise

Please see below the comments of our Planning & Licensing Committee, regarding the above application, following its meeting on Monday, 11 November:

Notice of application for a new Premises Licence under the Licensing Act 2003 in respect of Wo Fat Restaurant, 270-272 High Road, Loughton, IG10 1RB.

The Committee NOTED the contents of a letter of objection.

The Committee OBJECTED to this application on the grounds of the prevention of public nuisance. Members considered that 11pm was the latest closing time that should be permitted, to protect the amenity of residents living in neighbouring properties.

I would be most grateful if you could acknowledge receipt of this notification.

Kind regards
Debra

Debra Paris
Planning and Licensing Committee Clerk Loughton Town Council
Loughton Library & Town Hall, Traps Hill, Loughton, IG10 1HD
Tel: 020 8508 4200
Fax: 020 8508 4400
E-mail contact@loughton-tc.gov.uk
Web: www.loughton-tc.gov.uk



COUNTDOWN TO CHRISTMAS

Remember the date – Friday 6 December 2019 from 3.30-5.30pm

Free entertainment, fun fair rides and lots more...

The Broadway, Debden, Loughton IG10 3SP



facebook

By contacting Loughton Town Council you agree that your contact details may be held and processed for the purpose of corresponding with you. You may request access to the information we hold on you and you may request to be removed as a contact at any time by emailing: contact@loughton-tc.gov.uk A copy of Loughton Town Council's Privacy Notice may be viewed at: <https://tinyurl.com/y8sxohqs>

Loughton Residents Association Plans Group



[REDACTED]
02 November 2019

LICENSING APPLICATION, 270-272 High Road Loughton

This restaurant has residential units above the premises and behind the premises. Indeed, all the roads leading to and from the restaurant are residential, including the High Road, which has residential units above and behind the shops.

Many residents will be in bed by 11pm, and most by midnight.

Under the provisions relating the prevention of public nuisance, we object to the proposal to vary the hours for the supply of alcohol, late night refreshments and the provision of recorded music beyond 11pm on any night of the week) because of the disturbance this would inevitably cause to residents nearby.

We think that 11pm is the latest that restaurant with residential accommodation above should be providing alcohol and recorded music, as even if the premises are well-sound-proofed the noise of such customers - and their vehicles - leaving late at night, at a time when other daytime noises are much reduced, would obviously disturb residents.

Customers leaving up to and at closing time will congregate outside the premises waiting for taxis, or will drive away along the High Road or Traps Hill. Staff will of course leave some time after closing time, and will also congregate outside the premises waiting for taxis, or will drive away along the High Road or Traps Hill.

Even if the premises are well-sound-proofed and windows are kept closed, the noise of customers and staff leaving after 11pm, at a time when other daytime noises are much reduced, would obviously disturb residents

If the Licensing sub-committee intend to approve the application, then we urge them to impose earlier licensing hours than have been requested.

Yours sincerely

[REDACTED]

David Linnell, for LRA Plans Group.

Denise Bastick

From: Sarah Rosenbloom [REDACTED]
Sent: 02 November 2019 06:56
To: Licensing
Subject: re Wo Fat licence

CAUTION: This Message originated outside of Epping Forest District Council. Do not click links or open attachments unless you recognise the sender and know the contents is safe.

We received a letter stating that wo fat has applied for a late licence to serve alcohol. We live on habgood road, and we strongly feel that this will cause more noise disturbance to the local community which is already very loud during the weekend and bring in people who will cause anti social behaviour during this time, Therefore we contest the requested licence.

[REDACTED]
Loughton
Essex

Kind regards
Sarah Trenam

Agreed conditions

Denise Bastick

From: Peter Jones 42007706 [REDACTED]
Sent: 14 November 2019 08:29
To: Licensing
Cc: Tom CHEUNG
Subject: RE: Wo Fat, 270-272 High Road, Loughton - Application for a Premises Licence
Attachments: Wo Fat, Loughton - Recommended Conditions.docx

CAUTION: This Message originated outside of Epping Forest District Council. Do not click links or open attachments unless you recognise the sender and know the contents is safe.

Good morning,

Further to the below correspondence and agreement to the recommended conditions. Essex Police make no representations.

Peter



Peter Jones (7706) MIOL MBII
Licensing Officer – Epping Forest & Harlow
☎ 01279625405 (Ext: 313604) [REDACTED]
📍 Loughton Police Station, 158 High Road, Loughton, IG104BE

From: Tom CHEUNG [REDACTED]
Sent: 13 November 2019 16:05
To: Peter Jones 42007706 [REDACTED]
Cc: EFDC Licensing <licensing@eppingforestdc.gov.uk>
Subject: Re: Wo Fat, 270-272 High Road, Loughton - Application for a Premises Licence

Dear Mr Jones,

Thank you for your earlier phone call and the email as well as the schedule of recommendations sought by Essex Police.

I am writing to agree and confirmed we will follow the law compliance of recommendations of all the three main conditions, which is include the **Prevention of Crime and Disorder, Prevention of Public Nuisance, and Protection of Children from Ham.**

Actually, we have been installed the CCTV in the premise that cover all entrances and exits. The system can kept for a 31 days of data. Signs has been display on all entrances and exits.

We will display the clear and legible notice requesting customers to respect local residents and leave the area quietly, and any area used for smoking should respect local residents.

A Challenge 24 scheme shall be operated. Staff and new staff training of mandatory age verification will take place.

If you have any further concern, please do not hesitate to contact me by phone or email.

We look forward your confirmation soon.

With warmest regards

Ying Cheung
Mobile: [REDACTED]

On Wednesday, 13 November 2019, 10:32:03 GMT, Peter Jones 42007706 [REDACTED] wrote:

Dear Sir,

Further to my earlier telephone call; please find attached a schedule of recommendations sought by Essex Police in respect of your application for a premises licence at Wo Fat, 270-272 High Road, Loughton.

Please advise by return email whether you are able to agree to these or not.

Kind regards,



Peter Jones (7706) MIOL MBII

Licensing Officer – Epping Forest & Harlow

☎ 01279625405 (Ext: 313604) [REDACTED]

✉ Loughton Police Station, 158 High Road, Loughton, IG104BE

This email and any other accompanying document(s) contain information from Kent Police and/or Essex Police, which is confidential or privileged. The information is intended to be for the exclusive use of the individual(s) or bodies to whom it is addressed. The content, including any subsequent replies, could be disclosable if relating to a criminal investigation or civil proceedings. If you are not the intended recipient, be aware that any disclosure, copying, distribution or other use of the contents of this information is prohibited. If you have received this email in error, please notify us immediately by contacting the sender or telephoning Kent Police on 01622 690690 or Essex Police on 01245 491491, as appropriate. For further information regarding Kent Police's or Essex Police's use of personal data please go to <https://www.kent.police.uk/hyg/privacy/> or <https://www.essex.police.uk/hyg/privacy/>. Additionally for our Terms and Conditions please go to <https://www.kent.police.uk/hyg/terms-conditions/> or <https://www.essex.police.uk/hyg/terms-conditions/>

This email and any other accompanying document(s) contain information from Kent Police and/or Essex Police, which is confidential or privileged. The information is intended to be for the exclusive use of the individual(s) or bodies to whom it is addressed. The content, including any subsequent replies, could be disclosable if relating to a criminal investigation or civil proceedings. If you are not the intended recipient, be aware that any disclosure, copying, distribution or other use of the contents of this information is prohibited. If you have received this email in error, please notify us immediately by contacting the sender or telephoning Kent Police on 01622 690690 or Essex Police on 01245 491491, as appropriate. For further information regarding Kent Police's or Essex Police's use of personal data please go to <https://www.kent.police.uk/hyg/privacy/> or <https://www.essex.police.uk/hyg/privacy/>. Additionally for our Terms and Conditions please go to <https://www.kent.police.uk/hyg/terms-conditions/> or <https://www.essex.police.uk/hyg/terms-conditions/>

Prevention of Crime and Disorder

1. The premises shall have installed and maintain a closed circuit television surveillance (CCTV) system which at all times complies with the below requirements:
 - i. CCTV will be provided in the form a recordable system, capable of providing pictures of evidential quality in all lighting conditions particularly facial recognition;
 - ii. CCTV cameras shall cover all entrances and exits and the areas where alcohol sales take place;
 - iii. Equipment must be maintained in good working order, be correctly time and date stamped, recordings must be kept in good working order and kept for a minimum period of 31 days;
 - iv. Upon the reasonable request of the police or licensing authority staff, within 48 hours viewable copies of recordings will be provided.
2. Signs must be displayed at all entrances and exits advising customers that CCTV is operating at the premises and shall be a minimum size of 200 x 148 mm and clearly legible at all times when the premises conducts licensable activities.
3. Substantial food and non-intoxicating beverages shall be available in all parts of the premises where alcohol is sold or supplied for consumption on the premises at all times.
4. No alcohol may be supplied by an individual unless that individual has the written consent of the Designated Premises Supervisor or other employed Personal Licence Holder. A written record of this consent must be retained on the premises at all times when such an individual supplies or proposes to supply alcohol and be made available immediately upon reasonable request of the police or licensing authority.
5. In addition to water, other non-alcoholic beverages shall be available at all times whilst alcohol sale or supply takes place.

Prevention of Public Nuisance

6. Clear and legible notices must be prominently displayed at all exits requesting customers to respect local residents and leave the area quietly.
7. Clear and legible notices must be prominently displayed at any area used for smoking requesting customers to respect local residents and use the area quietly.
8. The premises must operate as a restaurant:
 - i. In which customers must be seated at a table;
 - ii. Which provides substantial table meals that are prepared on the premises and are served and consumed at the table;
 - iii. Which do not provide any take away service of food or drink for immediate consumption; and
 - iv. Where alcohol must not be sold, supplied, or consumed on the premises otherwise than to persons who are taking substantial table meals and provided always that the consumption of alcohol by such persons is ancillary to taking such meals.
9. Service of alcohol shall be by waiter/waitress only to patrons seated at a table and who have or intend to have a substantial meal.

10. No persons shall be supplied with alcohol at a bar or place of similar description within or outside the premises.

Protection of Children from Harm

11. A Challenge 25 scheme shall be operated, whereby any person who appears to be under the age of 25 years of age is required to produce on request an item which meets the mandatory age verification requirement and is either a:
- Proof of age card bearing the PASS Hologram;
 - Photocard driving licence;
 - Passport; or
 - Ministry of Defence Identity Card.
12. The premises shall clearly display signs at the entrance advising customers that a 'Challenge 25' policy is in force.
13. A refusals record shall be maintained at the premises which details all refusals to sell alcohol. Each entry shall, as a minimum, record the date and time of the refusal and the name of the staff member refusing the sale.
14. All entries must be made as soon as possible and in any event within 4 hours of the refusal and the record must be made immediately available to police, trading standards or licensing authority staff upon reasonable request. The refusals record shall either be electronic or maintained in a bound document and retained for at least 12 months from the date of the last entry.